

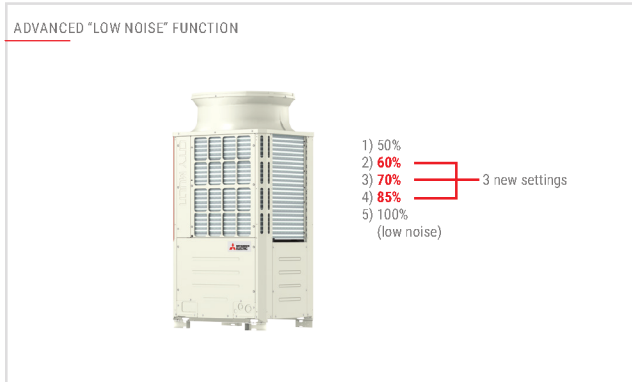

Advanced "Low Noise" function

"Low noise" mode can now be selected from five different settings: 85%, 70%, 60% and 50% (values referring to fan speed). Noise reduction is directly configurable from the control board of the outdoor unit. Different settings can be selected based on the installation requirements (in applications with special noise constraints).



New fan blade profile

The new YNW series fan has been completely redesigned to match the new four-sided battery. The profile of the fins has been optimised to minimise fluid flow losses.

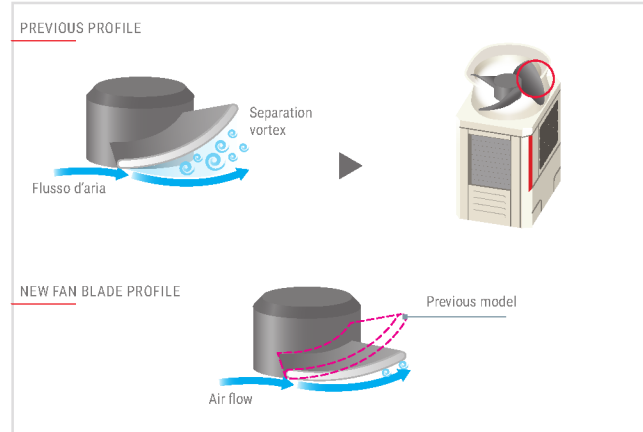

Key Technologies

Technical specifications

MODEL		PUHY-P280YNW-A(-BS)	PUHY-P250YNW-A(-BS)	PUHY-P300YNW-A(-BS)	PUHY-P350YNW-A(-BS)	PUHY-P400YNW-A(-BS)	PUHY-P450YNW-A(-BS)	PUHY-P500YNW-A(-BS)	PUHY-P400YSNW-A(-BS)	PUHY-P450YSNW-A(-BS)		
Modules		PUHY-P200YNW-A	PUHY-P250YNW-A	PUHY-P300YNW-A	PUHY-P350YNW-A	PUHY-P400YNW-A	PUHY-P450YNW-A	PUHY-P500YNW-A	PUHY-P200YNW-A PUHY-P250YNW-A	PUHY-P200YNW-A PUHY-P250YNW-A		
Power supply	V/Hz/n°	3-fase 380-415V 50Hz										
Cooling	Capacity*1	kW	22,4	28	33,5	40	45	50	56	45	50	
	Power input	kW	4,24	5,78	7,66	9,87	11,47	12,22	12,52	8,77	10,22	
	EER		5,28	4,84	4,37	4,05	3,92	4,09	4,47	5,13	4,89	
	SEER		8,44	8,47	8	7,72	7,75	7,86	7,66	8,35	8,33	
Temperature operating field	Indoor WB °C		+15~+24	+15~+24	+15~+24	+15~+24	+15~+24	+15~+24	+15~+24	+15~+24	+15~+24	
	Outdoor DB °C		-5~+52	-5~+52	-5~+52	-5~+52	-5~+52	-5~+52	-5~+52	-5~+52	-5~+52	
Heating	Capacity*2	kW	25	31,5	37,5	45	50	56	63	50	56	
	Power input	kW	4,58	6,04	7,86	8,51	13,4	13,42	14,61	9,45	10,85	
	COP		5,45	5,21	5	4,7	3,73	4,17	4,31	5,29	5,16	
	SCOP		4,7	4,42	4,24	3,97	3,77	3,68	3,69	4,55	4,42	
Temperature operating field	Indoor WB °C		+15~+27	+15~+27	+15~+27	+15~+27	+15~+27	+15~+27	+15~+27	+15~+27	+15~+27	
	Outdoor DB °C		-20~+15,5	-20~+15,5	-20~+15,5	-20~+15,5	-20~+15,5	-20~+15,5	-20~+15,5	-20~+15,5	-20~+15,5	
Sound power level*3	dB(A)	58/59	60/61	61/64,5	62/64	65/67	65,5/69,5	63,5/66,5	61/62	62/63		
Connectable indoor units	Total capacity		50-130%	50-130%	50-130%	50-130%	50-130%	50-130%	50-130%	50-130%		
	Model/Quantity	CITY MULTI	P15-P250/1-17	P15-P250/1-21	P15-P250/1-26	P15-P250/1-30	P15-P250/1-34	P15-P250/1-39	P15-P250/1-43	P15-P250/1-34	P15-P250/1-39	
Ø Ref. piping diameter	Liquid	mm	9,52	9,52	9,52	12,7	12,7	15,88	15,88	12,7	15,88	
	Gas	mm	22,2	22,2	22,2	28,58	28,58	28,58	28,58	28,58	28,58	
Fan	Type x quantity		Propoeller fan x 1	Propoeller fan x 1	Propoeller fan x 1	Propoeller fan x 2	Propoeller fan x 2	Propoeller fan x 2	Propoeller fan x 2	Propoeller fan x 4	Propoeller fan x 4	
	Air flow	m³/min	170	185	240	270	300	305	365	170 170	170 185	
Compressor	Type		Inverter scroll ermetic compressor									
	Motor output	kW	5,6	7	7,9	10,2	10,9	12,4	13	5,6 5,6	5,6 7	
External dimensions (HxLxD)	mm	1858x920x740	1858x920x740	1858x920x740	1858x1240x740	1858x1240x740	1858x1750x740	1858x1750x740	1858x1750x740	1858x920x740 1858x920x740	1858x920x740 1858x920x740	
Net weight	kg	225	225	228	278	278	294	337	450	450		
Ref. Charge R410A*/CO ₂ Eq	Ref. Charge R410A*/CO ₂ Eq	kg	6,5	6,5	6,5	9,8	9,8	10,8	10,8	13	13	
	CO ₂ eq.*4	Tons	13,57	13,57	13,57	20,46	20,46	22,55	22,55	27,14	27,14	

*1 Nominal cooling conditions: Indoor: 27°C DB / 19°C WB. Outdoor 35°C DB. Piping length 7.5 m, vertical difference 0 m.

*2 Nominal heating conditions: Indoor 20°C DB. Outdoor 7°C DB / 6°C WB. Piping length 7.5 m, vertical difference 0 m.

*3 Values measured in anechoic chamber (Cooling mode/Heating mode)

*4 GWP value of HFC R410A 2088 according to 517 / 2014.

The SEER and SCOP data are based on the EN14825 measurement standard

MODEL			PUHY-P500Y-SNW-A	PUHY-P550Y-SNW-A	PUHY-P600Y-SNW-A	PUHY-P650Y-SNW-A	PUHY-P700Y-SNW-A	PUHY-P750Y-SNW-A	PUHY-P800Y-SNW-A	PUHY-P850Y-SNW-A	PUHY-P900Y-SNW-A
Modules			PUHY-P250YNW-A PUHY-P250YNW-A	PUHY-P250YNW-A PUHY-P300YNW-A	PUHY-P300YNW-A PUHY-P300YNW-A	PUHY-P300YNW-A PUHY-P350YNW-A	PUHY-P350YNW-A PUHY-P350YNW-A	PUHY-P350YNW-A PUHY-P400YNW-A	PUHY-P400YNW-A PUHY-P400YNW-A	PUHY-P400YNW-A PUHY-P450YNW-A	PUHY-P450YNW-A PUHY-P450YNW-A
Power supply	V/Hz/n*		3-phase 380-415V 50Hz								
Cooling	Capacity*1	kW	56	63	69	73	80	85	90	96	101
	Power input	kW	11,91	14,15	16,26	17,59	20,35	21,99	22,76	24,66	25,44
	EER		4,7	4,45	4,24	4,15	3,93	3,86	3,95	3,89	3,97
	SEER		8,35	8,08	7,85	7,82	7,63	7,63	7,68	7,75	7,8
Temperature operating field	Indoor WB	°C	+15~+24	+15~+24	+15~+24	+15~+24	+15~+24	+15~+24	+15~+24	+15~+24	+15~+24
	Outdoor DB	°C	-5~+52	-5~+52	-5~+52	-5~+52	-5~+52	-5~+52	-5~+52	-5~+52	-5~+52
Heating	Capacity*2	kW	63	69	76,5	81,5	88	95	100	108	113
	Power input	kW	12,45	14,26	16,52	19,53	21,15	24,54	24,39	28,05	27,9
	COP		5,06	4,83	4,63	4,17	4,16	3,87	4,1	3,85	4,05
	SCOP		4,28	4,18	4,09	3,9	3,87	3,76	3,71	3,61	3,56
Temperature operating field	Indoor WB	°C	+15~+27	+15~+27	+15~+27	+15~+27	+15~+27	+15~+27	+15~+27	+15~+27	+15~+27
	Outdoor DB	°C	-20~+15,5	-20~+15,5	-20~+15,5	-20~+15,5	-20~+15,5	-20~+15,5	-20~+15,5	-20~+15,5	-20~+15,5
Sound power level*3		dB(A)	63/64	63,5/66	64/67,5	66,5/68	65/67	67/68,5	67,5/71	68,5/71,5	68,5/72,5
Connectable indoor units	Total capacity		50-130%	50-130%	50-130%	50-130%	50-130%	50-130%	50-130%	50-130%	50-130%
	Model/Quantity	CITY MULTI	P15-P250/ 1-43	P15-P250/ 2-47	P15-P250/ 2-50	P15-P250/ 2-50	P15-P250/ 2-50	P15-P250/ 2-50	P15-P250/ 2-50	P15-P250/ 2-50	P15-P250/ 2-50
Ø Ref. piping diameter	Liquid	mm	15,88	15,88	15,88	15,88	19,05	19,05	19,05	19,05	19,05
	Gas	mm	28,58	28,58	28,58	28,58	34,93	34,93	34,93	41,28	41,28
Fan	Type x quantity		Propoeller fan x 2	Propoeller fan x 2	Propoeller fan x 2	Propoeller fan x 3	Propoeller fan x 4	Propoeller fan x 4	Propoeller fan x 4	Propoeller fan x 4	Propoeller fan x 4
	Air flow	m³/min	185 185	185 240	240 240	240 270	270 270	270 300	270 300	300 305	305 305
Compressor	Type		Scroll ermetico inverter								
	Motor output	kW	7 7	7 7,9	7,9 7,9	7,9 10,2	10,2 10,2	10,2 10,9	10,9 10,9	10,9 12,4	12,4 12,4
External dimentions	(HxLxD)	mm	1858x920x740 1858x920x740	1858x920x740 1858x920x740	1858x920x740 1858x920x740	1858x1240x740 1858x1240x740	1858x1240x740 1858x1240x740	1858x1240x740 1858x1240x740	1858x1240x740 1858x1240x740	1858x1240x740 1858x1240x740	1858x1240x740 1858x1240x740
	Net weight	kg	450	453	456	503	556	556	572	572	588
Ref. Charge R410*/CO ₂ Eq	Ref. Charge R410*/CO ₂ Eq	kg	13	13	13	16,3	19,6	19,6	20,6	20,6	21,6
	CO ₂ eq.*4	Tons	27,14	27,14	27,14	34,03	40,92	40,92	43,01	43,01	45,1

MODEL			PUHY-P950Y-SNW-A	PUHY-P1000Y-SNW-A	PUHY-P1050Y-SNW-A	PUHY-P1100Y-SNW-A	PUHY-P1150Y-SNW-A	PUHY-P1200Y-SNW-A	PUHY-P1250Y-SNW-A	PUHY-P1300Y-SNW-A	PUHY-P1350Y-SNW-A
Modules			PUHY-P250YNW-A PUHY-P350YNW-A PUHY-P350YNW-A	PUHY-P250YNW-A PUHY-P350YNW-A PUHY-P400YNW-A	PUHY-P250YNW-A PUHY-P400YNW-A PUHY-P400YNW-A	PUHY-P350YNW-A PUHY-P350YNW-A PUHY-P400YNW-A	PUHY-P350YNW-A PUHY-P400YNW-A PUHY-P400YNW-A	PUHY-P400YNW-A PUHY-P400YNW-A PUHY-P400YNW-A	PUHY-P400YNW-A PUHY-P400YNW-A PUHY-P450YNW-A	PUHY-P400YNW-A PUHY-P450YNW-A PUHY-P450YNW-A	PUHY-P450YNW-A PUHY-P450YNW-A PUHY-P450YNW-A
Power supply	V/Hz/n*		3-phase 380-415V 50Hz								
Cooling	Capacity*1	kW	108	113	118	124	130	136	140	146	150
	Power input	kW	26,13	27,74	29,35	31,87	33,82	35,69	36,17	37,24	37,78
	EER		4,13	4,07	4,02	3,89	3,84	3,81	3,87	3,92	3,97
	SEER		7,82	7,81	7,81	7,6	7,6	7,63	7,65	7,68	7,71
Temperature operating field	Indoor WB	°C	+15~+24	+15~+24	+15~+24	+15~+24	+15~+24	+15~+24	+15~+24	+15~+24	+15~+24
	Outdoor DB	°C	-5~+52	-5~+52	-5~+52	-5~+52	-5~+52	-5~+52	-5~+52	-5~+52	-5~+52
Heating	Capacity*2	kW	119,5	127	132	140	145	150	156	163	168
	Power input	kW	27,2	30,45	33,3	35,34	38,32	41,42	41,4	41,55	41,4
	COP		4,39	4,17	3,96	3,96	3,78	3,62	3,78	3,92	4,05
	SCOP		3,99	3,88	3,81	3,8	3,73	3,67	3,63	3,6	3,57
Temperature operating field	Indoor WB	°C	+15~+27	+15~+27	+15~+27	+15~+27	+15~+27	+15~+27	+15~+27	+15~+27	+15~+27
	Outdoor DB	°C	-20~+15,5	-20~+15,5	-20~+15,5	-20~+15,5	-20~+15,5	-20~+15,5	-20~+15,5	-20~+15,5	-20~+15,5
Sound power level*3		dB(A)	66/68	68/69,5	68,5/70,5	68,5/70	69/71	70/72	70/73	70,5/74,5	
Connectable indoor units	Total capacity		50-130%	50-130%	50-130%	50-130%	50-130%	50-130%	50-130%	50-130%	50-130%
	Model/Quantity	CITY MULTI	P15-P250/ 2-50	P15-P250/ 2-50	P15-P250/ 3-50	P15-P250/ 3-50	P15-P250/ 3-50	P15-P250/ 3-50	P15-P250/ 3-50	P15-P250/ 3-50	P15-P250/ 3-50
Ø Ref. piping diameter	Liquid	mm	19,05	19,05	19,05	19,05	19,05	19,05	19,05	19,05	19,05
	Gas	mm	41,28	41,28	41,28	41,28	41,28	41,28	41,28	41,28	41,28
Fan	Type x quantity		Propoeller fan x 5	Propoeller fan x 5	Propoeller fan x 5	Propoeller fan x 6	Propoeller fan x 6	Propoeller fan x 6	Propoeller fan x 6	Propoeller fan x 6	Propoeller fan x 6
	Air flow	m³/min	185 270 270	185 300 300	185 300 300	270 270 300	270 300 300	300 300 300	300 300 305	300 305 305	305 305 305
Compressor	Type		Scroll ermetico inverter								
	Motor output	kW	7 9,8 9,8	7 9,8 10,9	7 10,9 10,9	8 9,8 10,9	8 10,9 10,9	9,8 10,9 10,9	10,9 10,9 12,4	10,9 10,9 12,4	10,9 12,4 12,4
External dimentions	(HxLxD)	mm	1858x920x740 1858x1240x740 1858x1240x740	1858x920x740 1858x1240x740 1858x1240x740	1858x920x740 1858x1240x740 1858x1240x740	1858x1240x740 1858x1240x740 1858x1240x740	1858x1240x740 1858x1240x740 1858x1240x740	1858x1240x740 1858x1240x740 1858x1240x740	1858x1240x740 1858x1240x740 1858x1240x740	1858x1240x740 1858x1240x740 1858x1240x740	1858x1240x740 1858x1240x740 1858x1240x740
	Net weight	kg	781	781	781	834	834	834	850	866	882
Ref. Charge R410*/CO ₂ Eq	Ref. Charge R410*/CO ₂ Eq	kg	26,1	26,1	26,1	29,4	29,4	29,4	30,4	31,4	32,4
	CO ₂ eq.*4	Tons	54,5	54,5	54,5	61,39	61,39	61,39	63,47	65,56	67,65



Technical specifications

MODEL		PUHY-EP200YWN-A(-BS)	PUHY-EP250YWN-A(-BS)	PUHY-EP300YWN-A(-BS)	PUHY-EP350YWN-A(-BS)	PUHY-EP400YWN-A(-BS)	PUHY-EP450YWN-A(-BS)	PUHY-EP500YWN-A(-BS)	PUHY-EP400Y-SNW-A(-BS)	PUHY-EP450Y-SNW-A(-BS)	
Modules		PUHY-EP200YWN-A	PUHY-EP250YWN-A	PUHY-EP300YWN-A	PUHY-EP350YWN-A	PUHY-EP400YWN-A	PUHY-EP450YWN-A	PUHY-EP500YWN-A	PUHY-EP200YWN-A PUHY-EP200YWN-A	PUHY-EP250YWN-A PUHY-EP250YWN-A	
Power supply	V/Hz/n°	3-fase 380-415V 50Hz									
Cooling	Capacity*1	kW	22,4	28	33,5	40	45	50	56	45	50
	Power input	kW	4	5,49	6,96	8,75	10,46	11,1	12,41	8,27	9,67
	EER		5,6	5,1	4,81	4,57	4,3	4,5	4,51	5,44	5,17
	SEER		9,03	9,11	8,8	8,53	8,52	8,57	7,95	8,94	8,94
Temperature operating field	Indoor WB	°C	+15~+24	+15~+24	+15~+24	+15~+24	+15~+24	+15~+24	+15~+24	+15~+24	+15~+24
	Outdoor DB	°C	-5~+52	-5~+52	-5~+52	-5~+52	-5~+52	-5~+52	-5~+52	-5~+52	-5~+52
Heating	Capacity*2	kW	25	31,5	37,5	45	50	56	63	50	56
	Power input	kW	4,5	5,86	7,51	9,86	12,4	13,02	13,57	9,27	10,58
	COP		5,55	5,37	4,99	4,56	4,03	4,3	4,64	5,39	5,29
	SCOP		4,82	4,52	4,3	4,12	4,11	3,88	3,8	4,67	4,51
Temperature operating field	Indoor WB	°C	+15~+27	+15~+27	+15~+27	+15~+27	+15~+27	+15~+27	+15~+27	+15~+27	+15~+27
	Outdoor DB	°C	-20~+15,5	-20~+15,5	-20~+15,5	-20~+15,5	-20~+15,5	-20~+15,5	-20~+15,5	-20~+15,5	-20~+15,5
Sound power level*3		dB(A)	58/59	60/61	61/64,5	62/63,5	65/65,5	65,5/69,5	63,5/66,5	61/62	62/63
Connectable indoor units	Total capacity		50-130%	50-130%	50-130%	50-130%	50-130%	50-130%	50-130%	50-130%	50-130%
	Model/Quantity	CITY MULTI	P15-P250/1-17	P15-P250/1-21	P15-P250/1-26	P15-P250/1-30	P15-P250/1-34	P15-P250/1-39	P15-P250/1-43	P15-P250/1-34	P15-P250/1-39
Ø Ref. piping diameter	Liquid	mm	9,52	9,52	9,52	12,7	12,7	15,88	15,88	12,7	15,88
	Gas	mm	22,2	22,2	28,58	28,58	28,58	28,58	28,58	28,58	28,58
Fan	Type x quantity		Propoeller fan x 1	Propoeller fan x 1	Propoeller fan x 1	Propoeller fan x 2	Propoeller fan x 2	Propoeller fan x 2	Propoeller fan x 2	Propoeller fan x 2	Propoeller fan x 2
	Air flow	m³/min	170	185	240	270	270	305	365	170	170
Compressor	Type		Scroll ermetico inverter								
	Motor output	kW	5,6	7	7,9	9,8	10,9	12,4	13,3	5,6	5,6
External dimentions	(HxLxD)	mm	1858x920x740	1858x920x740	1858x920x740	1858x1240x740	1858x1240x740	1858x1240x740	1858x1750x740	1858x920x740 1858x920x740	1858x920x740 1858x920x740
Net weight		kg	231	231	235	285	305	305	342	462	462
Ref. Charge R410*/CO ₂ Eq	Ref. Charge R410*/CO ₂ Eq	kg	6,5	6,5	6,5	9,8	10,8	10,8	10,8	13	13
	CO ₂ Eq	Tons	13,57	13,57	13,57	20,46	22,55	22,55	22,55	27,14	27,14

Technical specifications

MODEL		PUHY-EP500Y-SNW-A	PUHY-EP550Y-SNW-A	PUHY-EP600Y-SNW-A	PUHY-EP650Y-SNW-A	PUHY-EP700Y-SNW-A	PUHY-EP750Y-SNW-A	PUHY-EP800Y-SNW-A	PUHY-EP850Y-SNW-A	PUHY-EP900Y-SNW-A	
Modules		PUHY-EP250YWN-A PUHY-EP250YWN-A	PUHY-EP250YWN-A PUHY-EP300YWN-A	PUHY-EP300YWN-A PUHY-EP300YWN-A	PUHY-EP250YWN-A PUHY-EP400YWN-A	PUHY-EP350YWN-A PUHY-EP350YWN-A	PUHY-EP350YWN-A PUHY-EP400YWN-A	PUHY-EP350YWN-A PUHY-EP450YWN-A	PUHY-EP400YWN-A PUHY-EP450YWN-A	PUHY-EP450YWN-A PUHY-EP450YWN-A	
Power supply	V/Hz/n°	3-fase 380-415V 50Hz									
Cooling	Capacity*1	kW	56	63	69	73	80	85	90	96	101
	Power input	kW	11,31	13,1	14,75	16,32	18	19,75	20,45	22,4	23,1
	EER		4,95	4,8	4,67	4,47	4,44	4,3	4,4	4,28	4,37
	SEER		8,98	8,79	8,64	8,53	8,45	8,43	8,44	8,49	8,5
Temperature operating field	Indoor WB	°C	+15~+24	+15~+24	+15~+24	+15~+24	+15~+24	+15~+24	+15~+24	+15~+24	+15~+24
	Outdoor DB	°C	-5~+52	-5~+52	-5~+52	-5~+52	-5~+52	-5~+52	-5~+52	-5~+52	-5~+52
Heating	Capacity*2	kW	63	69	76,5	81,5	88	95	100	108	113
	Power input	kW	12,09	13,77	15,79	18,47	19,85	22,88	23,3	26,66	27,07
	COP		5,21	5,01	4,84	4,41	4,43	4,15	4,29	4,05	4,17
	SCOP		4,39	4,27	4,13	4,15	4,02	4	3,88	3,85	3,76
Temperature operating field	Indoor WB	°C	+15~+27	+15~+27	+15~+27	+15~+27	+15~+27	+15~+27	+15~+27	+15~+27	+15~+27
	Outdoor DB	°C	-20~+15,5	-20~+15,5	-20~+15,5	-20~+15,5	-20~+15,5	-20~+15,5	-20~+15,5	-20~+15,5	-20~+15,5
Sound power level*3		dB(A)	63/64	63,5/66	64/67,5	66,5/67	65/66,5	67/67,5	67,5/70,5	68,5/71	68,5/72,5
Connectable indoor units	Total capacity		50-130%	50-130%	50-130%	50-130%	50-130%	50-130%	50-130%	50-130%	50-130%
	Model/Quantity	CITY MULTI	P15-P250/ 1-43	P15-P250/ 2-47	P15-P250/ 2-50	P15-P250/ 2-50	P15-P250/ 2-50	P15-P250/ 2-50	P15-P250/ 2-50	P15-P250/ 2-50	P15-P250/ 2-50
Ø Ref. piping diameter	Liquid	mm	15,88	15,88	15,88	15,88	19,05	19,05	19,05	19,05	19,05
	Gas	mm	28,58	28,58	28,58	28,58	34,93	34,93	34,93	41,28	41,28
Fan	Type x quantity		Propoeller fan x 2	Propoeller fan x 2	Propoeller fan x 2	Propoeller fan x 3	Propoeller fan x 4	Propoeller fan x 4	Propoeller fan x 4	Propoeller fan x 4	Propoeller fan x 4
	Air flow	m³/min	185	185	240	240	270	270	305	305	305
Compressor	Type		Scroll ermetico inverter								
	Motor output	kW	7	7	7,9	7	9,8	9,8	9,8	10,9	12,4
External dimentions	(HxLxD)	mm	1858x920x740 1858x920x740	1858x920x740 1858x920x740	1858x920x740 1858x920x740	1858x1240x740 1858x1240x740	1858x1240x740 1858x1240x740	1858x1240x740 1858x1240x740	1858x1240x740 1858x1240x740	1858x1240x740 1858x1240x740	1858x1240x740 1858x1240x740
Net weight		kg	462	466	470	536	570	590	590	610	610
Ref. Charge R410*/CO ₂ Eq	Ref. Charge R410*/CO ₂ Eq	kg	13	13	13	17,3	19,6	20,6	20,6	21,6	21,6
	CO ₂ Eq	Tons	27,14	27,14	27,14	36,12	40,92	43,01	43,01	45,1	45,1

*1 Nominal cooling conditions: Indoor: 27°C DB / 19°C WB. Outdoor 35°C DB. Piping length 7.5 m, vertical difference 0 m.
 *2 Nominal heating conditions: Indoor 20°C DB. Outdoor 7°C DB / 6°C WB. Piping length 7.5 m, vertical difference 0 m.
 *3 Values measured in anechoic chamber (Cooling mode/Heating mode)
 *4 GWP value of HFC R410A 2088 according to 517 / 2014.
 The SEER and SCOP data are based on the EN14825 measurement standard

Technical specifications

MODEL			PUHY-EP950Y-SNW-A	PUHY-EP1000Y-SNW-A	PUHY-EP1050Y-SNW-A	PUHY-EP1100Y-SNW-A	PUHY-EP1150Y-SNW-A	PUHY-EP1200Y-SNW-A	PUHY-EP1250Y-SNW-A	PUHY-EP1300Y-SNW-A	PUHY-EP1350Y-SNW-A	
Modules			PUHY-EP250YNW-A	PUHY-EP250YNW-A	PUHY-EP250YNW-A	PUHY-EP350YNW-A	PUHY-EP350YNW-A	PUHY-EP350YNW-A	PUHY-EP400YNW-A	PUHY-EP400YNW-A	PUHY-EP450YNW-A	
			PUHY-EP350YNW-A	PUHY-EP350YNW-A	PUHY-EP400YNW-A	PUHY-EP350YNW-A	PUHY-EP400YNW-A	PUHY-EP400YNW-A	PUHY-EP400YNW-A	PUHY-EP450YNW-A	PUHY-EP450YNW-A	
			PUHY-EP350YNW-A	PUHY-EP400YNW-A	PUHY-EP400YNW-A	PUHY-EP400YNW-A	PUHY-EP400YNW-A	PUHY-EP400YNW-A	PUHY-EP400YNW-A	PUHY-EP450YNW-A	PUHY-EP450YNW-A	
			PUHY-EP350YNW-A	PUHY-EP400YNW-A	PUHY-EP400YNW-A	PUHY-EP400YNW-A	PUHY-EP400YNW-A	PUHY-EP400YNW-A	PUHY-EP400YNW-A	PUHY-EP450YNW-A	PUHY-EP450YNW-A	
Power supply	V/Hz/n°		3-fase 380-415V 50Hz									
Cooling	Capacity*1		kW	108	113	118	124	130	136	140	146	150
	Power input		kW	23,62	25,33	27,05	28,56	30,56	32,58	32,98	33,85	34,3
	EER			4,57	4,46	4,36	4,34	4,25	4,17	4,24	4,31	4,37
	SEER			8,58	8,57	8,54	8,4	8,39	8,38	8,38	8,4	8,41
	Temperature operating field	Indoor WB	°C	+15~+24	+15~+24	+15~+24	+15~+24	+15~+24	+15~+24	+15~+24	+15~+24	+15~+24
Outdoor DB		°C	-5~+52	-5~+52	-5~+52	-5~+52	-5~+52	-5~+52	-5~+52	-5~+52	-5~+52	
Heating	Capacity*2		kW	119,5	127	132	140	145	150	156,5	163	168
	Power input		kW	25,79	28,7	31,26	33	35,6	38,34	39	39,81	40,24
	COP			4,63	4,42	4,22	4,24	4,07	3,91	4,01	4,09	4,17
	SCOP			4,11	4,09	4,09	4	4	4	3,91	3,83	3,77
	Temperature operating field	Indoor WB	°C	+15~+27	+15~+27	+15~+27	+15~+27	+15~+27	+15~+27	+15~+27	+15~+27	+15~+27
Outdoor DB		°C	-20~+15,5	-20~+15,5	-20~+15,5	-20~+15,5	-20~+15,5	-20~+15,5	-20~+15,5	-20~+15,5	-20~+15,5	
Sound power level*3			dB(A)	66/67,5	68/68,5	68,5/69	68,5/69	69/69,5	70/70,5	70/72	70/73,5	70,5/74,5
Connectable indoor units	Total capacity			50-130%	50-130%	50-130%	50-130%	50-130%	50-130%	50-130%	50-130%	
	Model/Quantity	CITY MULTI		P15-P250/ 2-50	P15-P250/ 2-50	P15-P250/ 3-50	P15-P250/ 3-50	P15-P250/ 3-50	P15-P250/ 3-50	P15-P250/ 3-50	P15-P250/ 3-50	
Ø Ref. piping diameter	Liquid	mm	19,05	19,05	19,05	19,05	19,05	19,05	19,05	19,05	19,05	
	Gas	mm	41,28	41,28	41,28	41,28	41,28	41,28	41,28	41,28	41,28	
Fan	Type x quantity			Propoeller fan x 5	Propoeller fan x 5	Propoeller fan x 5	Propoeller fan x 6	Propoeller fan x 6	Propoeller fan x 6	Propoeller fan x 6	Propoeller fan x 6	
	Air flow	m³/min		185	185	185	270	270	270	270	305	
				270	270	270	270	270	270	270	305	
Compressor	Type		Scroll ermetico inverter									
	Motor output	kW		7	7	7	9,8	9,8	10,9	10,9	10,9	12,4
				9,8	9,8	10,9	10,9	10,9	10,9	10,9	12,4	12,4
External dimentions	(HxLxD)	mm		1858x920x740	1858x920x740	1858x920x740	1858x1240x740	1858x1240x740	1858x1240x740	1858x1240x740	1858x1240x740	1858x1240x740
				1858x1240x740	1858x1240x740	1858x1240x740	1858x1240x740	1858x1240x740	1858x1240x740	1858x1240x740	1858x1240x740	1858x1240x740
				1858x1240x740	1858x1240x740	1858x1240x740	1858x1240x740	1858x1240x740	1858x1240x740	1858x1240x740	1858x1240x740	1858x1240x740
Net weight			kg	801	821	841	875	895	915	915	915	
Ref. Charge R410*/CO ₂ Eq	Ref. Charge R410*/CO ₂ Eq		kg	26,1	27,1	28,1	30,4	31,4	32,4	32,4	32,4	32,4
	CO ₂ eq.*4		Tons	54,5	56,58	58,67	63,47	65,56	67,65	67,65	67,65	67,65

*1 Nominal cooling conditions: Indoor: 27°C DB / 19°C WB. Outdoor 35°C DB. Piping length 7.5 m, vertical difference 0 m.

*2 Nominal heating conditions: Indoor 20°C DB. Outdoor 7°C DB / 6°C WB. Piping length 7.5 m, vertical difference 0 m.

*3 Values measured in anechoic chamber (Cooling mode/Heating mode)

*4 GWP value of HFC R410A 2088 according to 517 / 2014.

The SEER and SCOP data are based on the EN14825 measurement standard